

Easy Setup Instructions

This outboard is shipped **without oil** in the engine.
You must **add oil** before use.

BF8D • BFP8D
BF9.9D • BFP9.9D
BF15D • BFP15D
BF20D • BFP20D

- 1** Open the box and inspect the outboard motor for damage. If you find damage, contact the retailer.



- 2** Locate and read the Owner's Manual fully to understand how to install and operate the outboard motor correctly.



- 3** Install the motor on the centerline ^① of the boat's transom. Refer to the **INSTALLATION** section of the Owner's Manual.

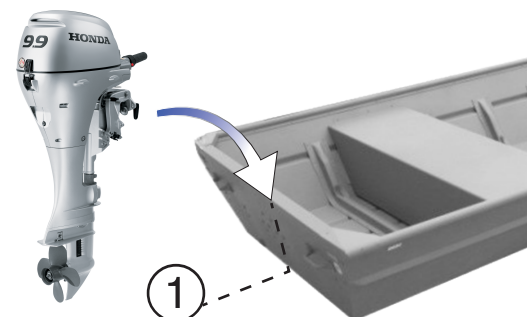

BF8D • BF9.9D approx. weight: 93 ~ 127 lbs
BF15D • BF20D approx. weight: 115 ~ 142 lbs

- 4** The antiventilation plate ^① of the motor should be 0 ~ 2 inches below the bottom of the boat. Be sure the idle port ^② is above the water level when the boat is fully loaded. If not, contact your retailer.

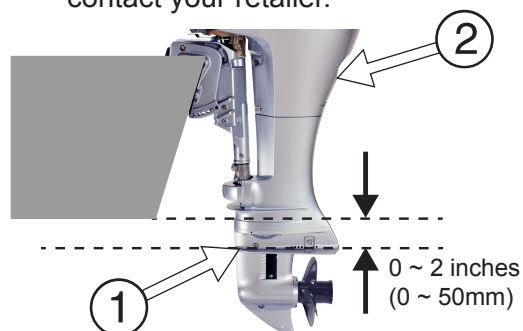

- 5** Attach the stern bracket to the boat transom by tightening the clamp screws ^① clockwise. Attach a safety rope from the boat to the hole in the stern bracket ^②.

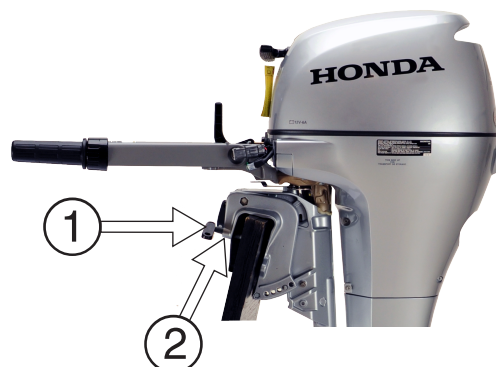

- 6** Lift the latch ^① up and remove the motor cover ^②.



- 7** Unscrew the oil fill cap ①. Add Honda 10W30 FC-W (or equivalent) engine oil, API category SG, SH, or SJ, to the upper limit mark on the dipstick ②. Do not overfill.

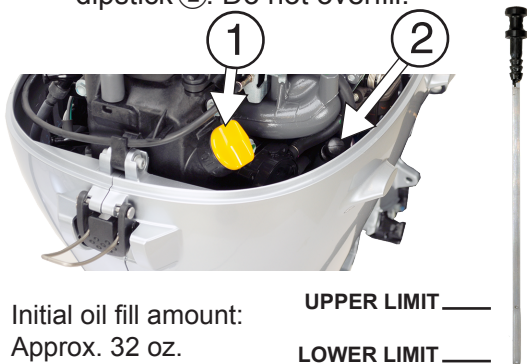

- 8** Reinstall the motor cover ①. Connect the supplied fuel hose ② to the outboard motor fuel hose connector ③.



- 9** Add fresh Regular grade (pump octane of 86 or higher) gasoline containing no more than 10% ethanol (E10) to the portable fuel tank and then connect the fuel hose to the tank.



Starting The Engine & Break-in

Refer to the OPERATION section of the Owner's Manual. Follow the instructions for starting the engine and performing the break-in procedure for the outboard motor.

Proper break-in operation allows the moving parts to wear in smoothly for best performance and long service life. Avoid continuous operation at a steady speed.

Registering Your Outboard Motor

Register your outboard motor to receive important service information and updates.

Visit marine.honda.com and click on Service & Support, then **Product Registration**.

Have a question or a problem?

Most questions or concerns can be answered by reading the Owner's Manual or contacting the retailer where you purchased your Honda outboard motor.

Where is a dealer near me?

You can find the closest Authorized Honda Marine Dealer to you by visiting marine.honda.com and clicking on **Find A Dealer**.